

6 PIN SDIP INTELLIGENT POWER and GATE DRIVE INTERFACE PHOTOCOUPLER ELS680-G series

Preliminary

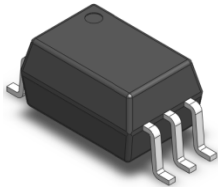

Features

- Compliance Halogens Free
(Br < 900 ppm, Cl < 900 ppm, Br+Cl < 1500 ppm)
- Pb free and RoHS compliant
- Compliance with EU REACH.
- High isolation voltage between input and output (Viso=5000 Vrms)
- UL and cUL pending
- VDE pending
- NEMKO pending
- FIMKO pending
- SEMKO pending
- DEMKO pending
- CQC pending

Schematic

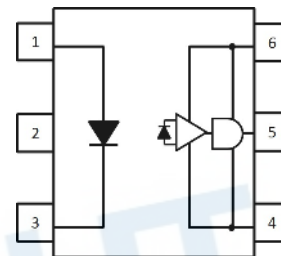

A 0.1 μ F bypass capacitor must be connected between pins 6 and 4³

Pin Configuration

- 1: Anode
- 2: No Connection
- 3: Cathode
- 4: V_{EE}
- 5: V_{out}
- 6: V_{CC}

This is a preliminary specification intended for design purposes and subject to change without prior notice.

Description

The ELS680-G series devices each consists of an infrared emitting diode, optically coupled to a high speed integrated photo detector logic gate with a totem output. The totem pole output eliminates the need for a pull-up resistor and allows for a direct-drive Intelligent Power Module or gate drive. The devices are packaged in a 6-pin small DIP package.

Applications

- IPM Interface Isolation
- Isolated IGBT/MOSFET Gate Drive
- AC and Brushless DC Motor Drives
- Industrial Inverters

Truth Table

Input	Output
H	H
L	L

Absolute Maximum Ratings (Ta=25°C)

	Parameter	Symbol	Rating	Unit
Input	Forward current	I_F	25	mA
	Reverse voltage	V_R	5	V
	Power dissipation	P_{IN}	75	mW
Output	Average Output current	$I_{O(AVG)}$	60	mA
	Supply voltage	V_{CC}	30	V
	Power dissipation	P_O	270	mW
Total Power Dissipation		P_{TOT}	350	mW
Isolation voltage ^{*1}		V_{ISO}	5000	Vrms
Operating temperature		T_{OPR}	-40 ~ +100	°C
Storage temperature		T_{STG}	-55 ~ +125	°C
Soldering temperature ^{*2}		T_{SOL}	260	°C

Notes:

^{*1} AC for 1 minute, R.H.= 40 ~ 60% R.H. In this test, pins 1, 2, 3 are shorted together, and pins 4, 5, 6, are shorted together.

^{*2} For 10 seconds.

Electrical Characteristics (Ta=-40 to 100 °C unless specified otherwise)**Input**

Parameter	Symbol	Min.	Typ.	Max.	Unit	Condition
Forward Voltage	V_F	-	1.5	1.8	V	$I_F=10\text{mA}$
Reverse Voltage	I_R	-	-	10	μA	$V_R=5\text{V}$
Input Capacitance	C_{IN}	-	60	-	pF	$V_F=0\text{V}$, $f=1\text{MHz}$

Output

Parameter	Symbol	Min	Typ.	Max.	Unit	Condition
High Level Supply Current	I_{CCH}	-	-	3.2	mA	$V_{CC}=5.5\text{V}$, $I_F=10\text{mA}$
Low Level Supply Current	I_{CCL}	-	-	3.2	mA	$V_{CC}=5.5\text{V}$, $I_F=0\text{mA}$
Logic High Short Circuit Output Current,	I_{OSH}	-	-	-60	mA	$V_{CC}=5.5\text{V}$, $I_F=10\text{mA}$, $I_O=\text{Open}$
Logic Low Short Circuit Output Current,	I_{OSL}	60	-		mA	$V_{CC}=V_O=5.5\text{V}$, $V_F=0\text{V}$

Transfer Characteristics (Ta=-40 to 100 °C unless specified otherwise)

Parameter	Symbol	Min	Typ.	Max.	Unit	Condition
High Level Output Voltage	V_{OH}	$V_{CC}-0.5$	-	-	V	$V_{CC}=4.5\text{V}$, $I_F=10\text{mA}$, $I_O=-0.4\text{mA}$
Low Level Output Voltage	V_{OL}	-	-	$V_{EE}+0.5$	V	$V_{CC}=4.5\text{V}$, $I_F=0\text{mA}$, $I_O=6.4\text{mA}$
Input Threshold Current	I_{FT}	-	2.5	5	mA	$V_{CC}=4.5\text{V}$
Input-Output Resistance	R_{I-O}	-	10^{12}	-	Ω	$V_{I-O}=500\text{V DC}$
Input-Output Capacitance	C_{I-O}	-	0.6	-	pF	$V_{I-O}=0\text{V DC}$, $f=1\text{MHz}$

Switching Characteristics ($T_a=-40$ to $100\text{ }^{\circ}\text{C}$, $V_{CC}=4.5\text{V}$, $I_F=10\text{mA}$ unless specified otherwise)

Parameter	Symbol	Min	Typ.	Max.	Unit	Condition
Propagation Delay Time to Output High Level* ⁵	t_{PHL}	-	130	350	ns	$V_{CC}=4.5\text{V}$, $I_F=10\text{mA}$ $T_A=25\text{ }^{\circ}\text{C}$
Propagation Delay Time to Output Low Level* ⁶	t_{PLH}	-	140	350	ns	$V_{CC}=4.5\text{V}$, $I_F=10\text{mA}$ $T_A=25\text{ }^{\circ}\text{C}$
Pulse Width Distortion	$ t_{PHL} - t_{PLH} $	-	-	250	ns	$V_{CC}=4.5\text{V}$, $I_F=10\text{mA}$ $T_A=25\text{ }^{\circ}\text{C}$
Output Rise Time* ⁷	t_r	-	9	-	ns	$V_{CC}=4.5\text{V}$, $I_F=10\text{mA}$ $T_A=25\text{ }^{\circ}\text{C}$
Output fall time* ⁸	t_f	-	6	-	ns	$V_{CC}=4.5\text{V}$, $I_F=10\text{mA}$ $T_A=25\text{ }^{\circ}\text{C}$
Common Mode Transient Immunity at Logic High* ³	CM_H	10	-	-	KV/ μs	$V_{CM}=1500\text{Vp-p}$, $I_F=7.5\text{mA}$, $V_{CC}=5\text{V}$, $T_A=25\text{ }^{\circ}\text{C}$
Common Mode Transient Immunity at Logic Low* ³	CM_L	10	-	-	KV/ μs	$V_{CM}=1500\text{Vp-p}$, $I_F=0\text{mA}$, $V_{CC}=5\text{V}$, $T_A=25\text{ }^{\circ}\text{C}$

EVERLIGHT

Order Information

Part Number

ELS680X(Y) -VG

Note

- EL = denotes EVERLIGHT
- S680 = part no.
- X = lead type(P)
- Y = Tape and reel option (TA, TB)
- V = VDE (optional)
- G = Halogens free

Option	Description	Packing quantity
P(TA)	Surface mount lead form + TA tape & reel option	1000 units per reel
P(TB)	Surface mount lead form + TB tape & reel option	1000 units per reel

EVERLIGHT

Package Dimension (Dimensions in mm)

P Type

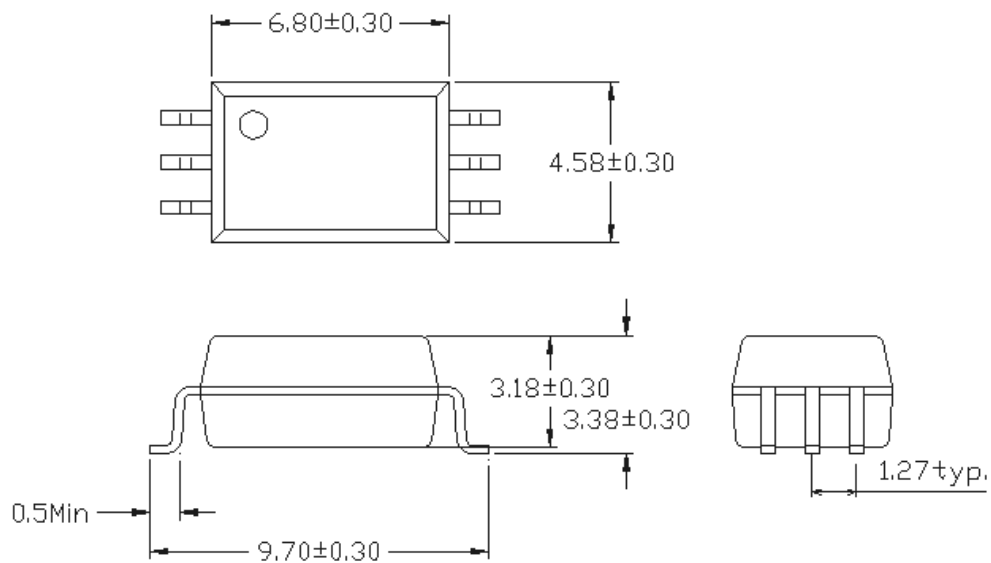

Recommended pad layout for surface mount leadform

For P Type:

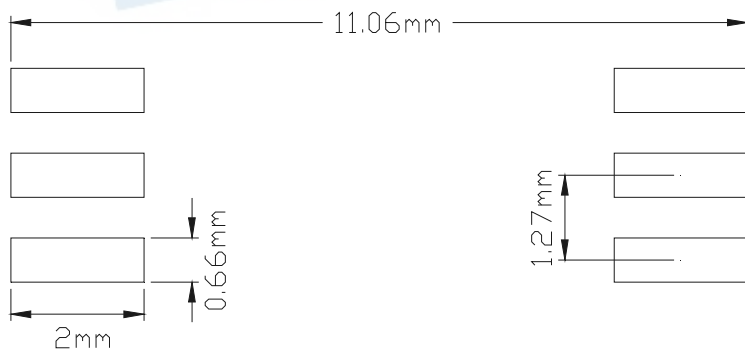

Device Marking

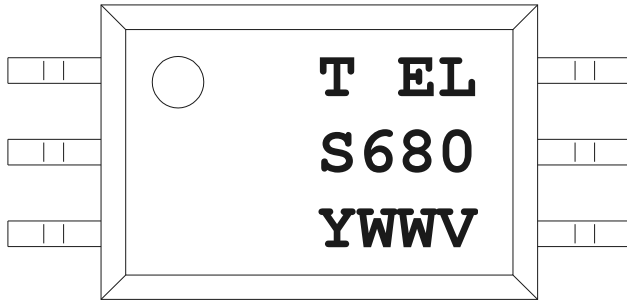

Notes

T	denotes Factory T : made in Taiwan
EL	denotes EVERLIGHT
S680	denotes Device Number
Y	denotes 1 digit Year code
WW	denotes 2 digit Week code
V	denotes VDE (optional)

Tape & Reel Packing Specifications

Option TA

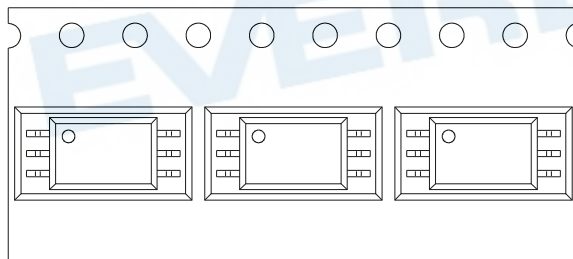

Direction of feed from reel

Option TB

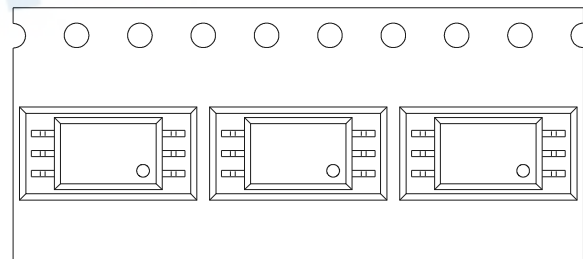

Direction of feed from reel

Tape dimension

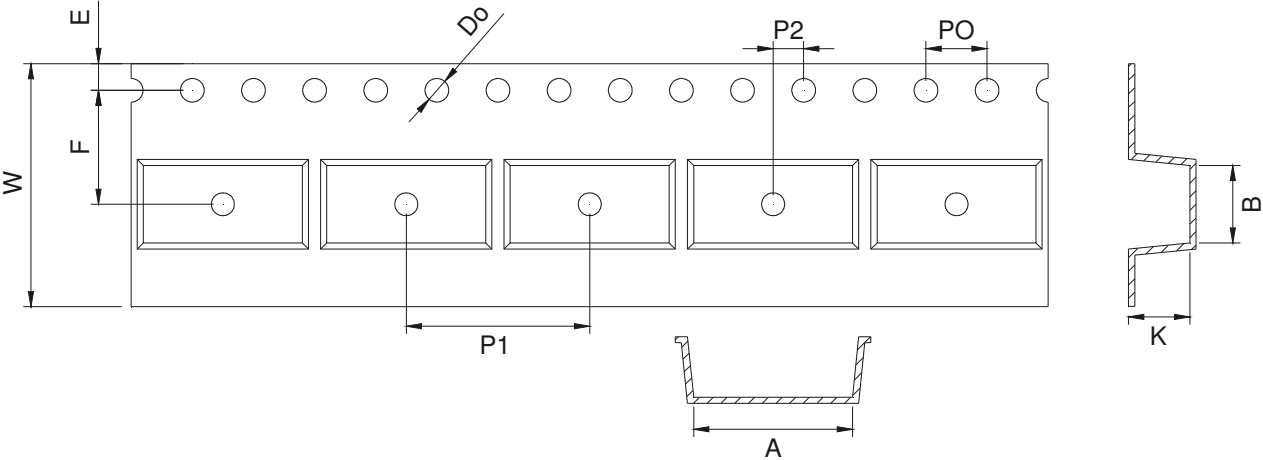

Dimension No.	A	B	Do	E	F	t
Dimension(mm) P	10.4 ± 0.1	5.1 ± 0.1	1.55 ± 0.1	1.75 ± 0.1	7.5 ± 0.1	0.4 ± 0.1
Dimension No.	PO	P1	P2	W	K	
Dimension(mm) P	4.0 ± 0.1	12.0 ± 0.1	2.0 ± 0.1	16.0 ± 0.3	4.0 ± 0.1	

Precautions for Use

1. Soldering Condition

1.1 (A) Maximum Body Case Temperature Profile for evaluation of Reflow Profile

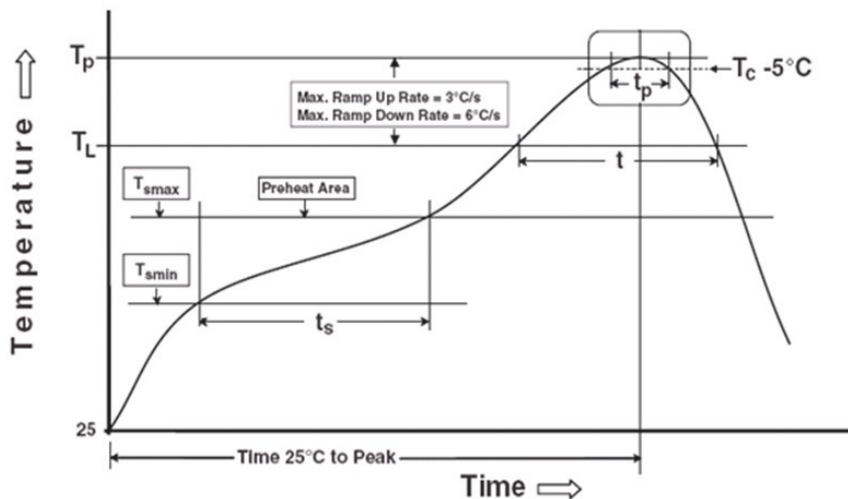

Note:

Reference: IPC/JEDEC J-STD-020D

Preheat

Temperature min (T_{smin})	150 °C
Temperature max (T_{smax})	200 °C
Time (T_{smin} to T_{smax}) (t_s)	60-120 seconds
Average ramp-up rate (T_{smax} to T_P)	3 °C/second max

Other

Liquidus Temperature (T_L)	217 °C
Time above Liquidus Temperature (t_L)	60-100 sec
Peak Temperature (T_P)	260 °C
Time within 5 °C of Actual Peak Temperature: $T_P - 5^\circ\text{C}$	30 s
Ramp- Down Rate from Peak Temperature	6 °C /second max.
Time 25°C to peak temperature	8 minutes max.
Reflow times	3 times

DISCLAIMER

1. Above specification may be changed without notice. EVERLIGHT will reserve authority on material change for above specification.
2. The graphs shown in this datasheet are representing typical data only and do not show guaranteed values.
3. When using this product, please observe the absolute maximum ratings and the instructions for use outlined in these specification sheets. EVERLIGHT assumes no responsibility for any damage resulting from use of the product which does not comply with the absolute maximum ratings and the instructions included in these specification sheets.
4. These specification sheets include materials protected under copyright of EVERLIGHT. Reproduction in any form is prohibited without the specific consent of EVERLIGHT.
5. This product is not intended to be used for military, aircraft, automotive, medical, life sustaining or life saving applications or any other application which can result in human injury or death. Please contact authorized Everlight sales agent for special application request.
6. Statements regarding the suitability of products for certain types of applications are based on Everlight's knowledge of typical requirements that are often placed on Everlight products in generic applications. Such statements are not binding statements about the suitability of products for a particular application. It is the customer's responsibility to validate that a particular product with the properties described in the product specification is suitable for use in a particular application. Parameters provided in datasheets and/or specifications may vary in different applications and performance may vary over time. All operating parameters, including typical parameters, must be validated for each customer application by the customer's technical experts. Product specifications do not expand or otherwise modify Everlight's terms and conditions of purchase, including but not limited to the warranty expressed therein.